

EL BRONCO D ALLENDE ESTATES

TRACTS 7-C AND 8-D, BLOCK 34, YSLETA GRANT
CITY OF EL PASO, EL PASO COUNTY, TEXAS.
CONTAINING:
100,748.72 SQ. FT. OR 2.3128 ACRES ±

PRELIMINARY

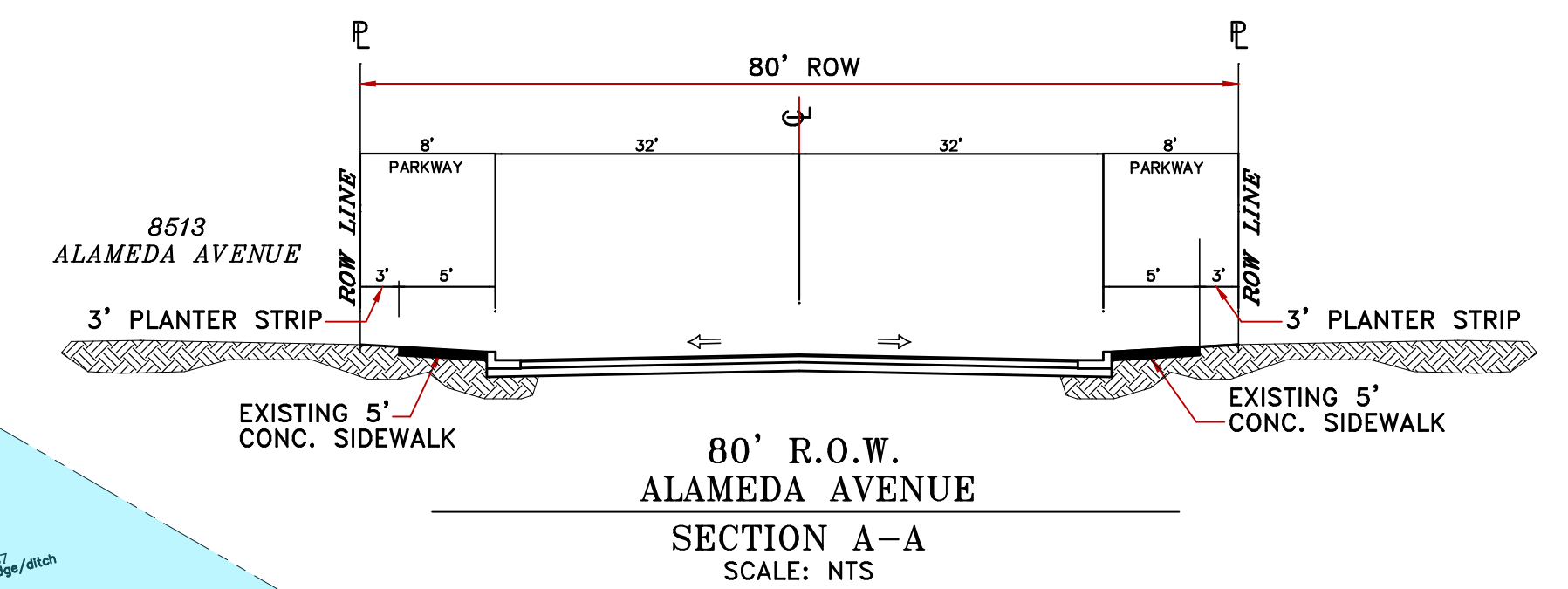

| CURVE | LENGTH | RADIUS | DELTA | BEARING | CHORD |
|-------|--------|--------|-----------|-------------|-------|
| C1 | 31.42 | 20.00 | 90°00'00" | S16°31'00"W | 28.28 |
| C2 | 29.71 | 87.29 | 19°30'00" | S71°16'00"W | 29.57 |

| | |
|------|---------------------|
| CBW | = CINDER BLOCK WALL |
| NG | = NATURAL GROUND |
| PVM | = PAVEMENT |
| G | = GUTTER |
| TC | = TOP OF CURB |
| RW | = ROCKWALL |
| CONC | = CONCRETE |
| EOP | = EDGE OF PAVEMENT |
| ☐ | = LIGHT POLE |
| ⊙ | = WATER METER |
| ⊙ | = MANHOLE |
| ⊙ | = POWER POLE |
| — | = GUY WIRE |
| ⊙ | = WATER BOX |
| ⊙ | = TEL RISER |
| ⊙ | = SIGN |
| — | = OVERHEAD ELECTRIC |
| ⊙ | = ROCKWALL |
| — | = CHAINLINK FENCE |
| ⊙ | = PIPE FENCE |
| → | = DRAINAGE FLOW |

BENCH MARK:
FOUND CITY MONUMENT AT DORBANDT CIRCLE
OPP. 8536 DORBANDT CIRCLE
BENCH MARK ELEV. = 3662.56' CITY DATUM
CONTOUR INTERVAL 1 FOOT
CONTOUR LABEL 5 FEET

- NOTES:
- RESTRICTIVE COVENANTS FOR THIS SUBDIVISION ARE FILED IN THE OFFICE OF THE COUNTY CLERK, DEED AND RECORD SECTION.
INSTRUMENT No. _____ DATE _____
 - TAX CERTIFICATE FOR THIS SUBDIVISION ARE FILED IN THE OFFICE OF THE COUNTY CLERK, DEED AND RECORD SECTION.
INSTRUMENT No. _____ DATE _____
 - LOT CORNERS WILL BE SET UPON COMPLETION OF CONSTRUCTION OF ROADWAYS AND UTILITIES.
 - THIS PROPERTY LIES IN ZONES "X", AS DESIGNATED BY F.E.M.A.; CITY OF EL PASO, 02/16/2006, COMMUNITY PANEL NO. 480214-0048-C.
 - THIS SUBDIVISION SHALL PROVIDE FOR POSTAL DELIVERY SERVICE. THE SUBDIVIDER WILL COORDINATE INSTALLATION AND CONSTRUCTION WITH THE UNITED STATES POSTAL SERVICE IN DETERMINING THE TYPE OF DELIVERY SERVICE FOR THE PROPOSED SUBDIVISION. IN ALL CASES, THE TYPE AND LOCATION OF DELIVERY SERVICE SHALL BE SUBJECT TO THE APPROVAL OF THE UNITED STATES POSTAL SERVICE.
 - WATER SUPPLY AND SEWAGE DISPOSAL WILL BE PROVIDED BY THE EL PASO WATER UTILITIES.
 - ALL STORMWATER RUN-OFF DISCHARGE VOLUMES SHALL BE RETAINED WITHIN THIS SUBDIVISION LIMITS IN COMPLIANCE WITH PROVISIONS OF (DSC, 19.19.010A, AND DDM 11.1).
 - THIS PROPERTY LIES IN THE YSLETA INDEPENDENT SCHOOL DISTRICT.

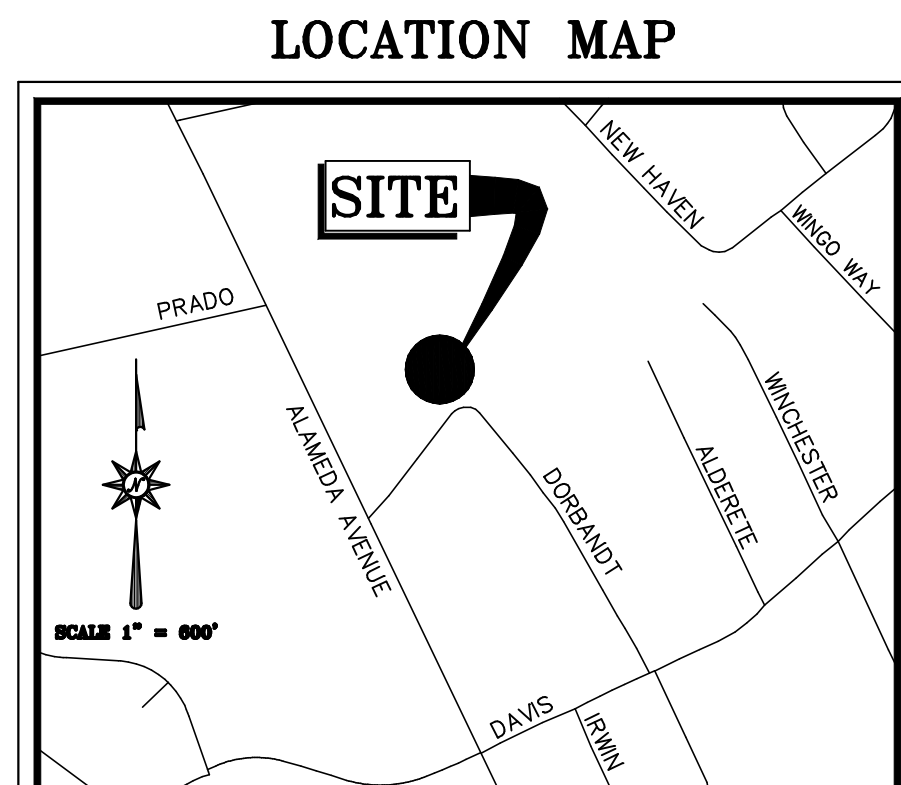
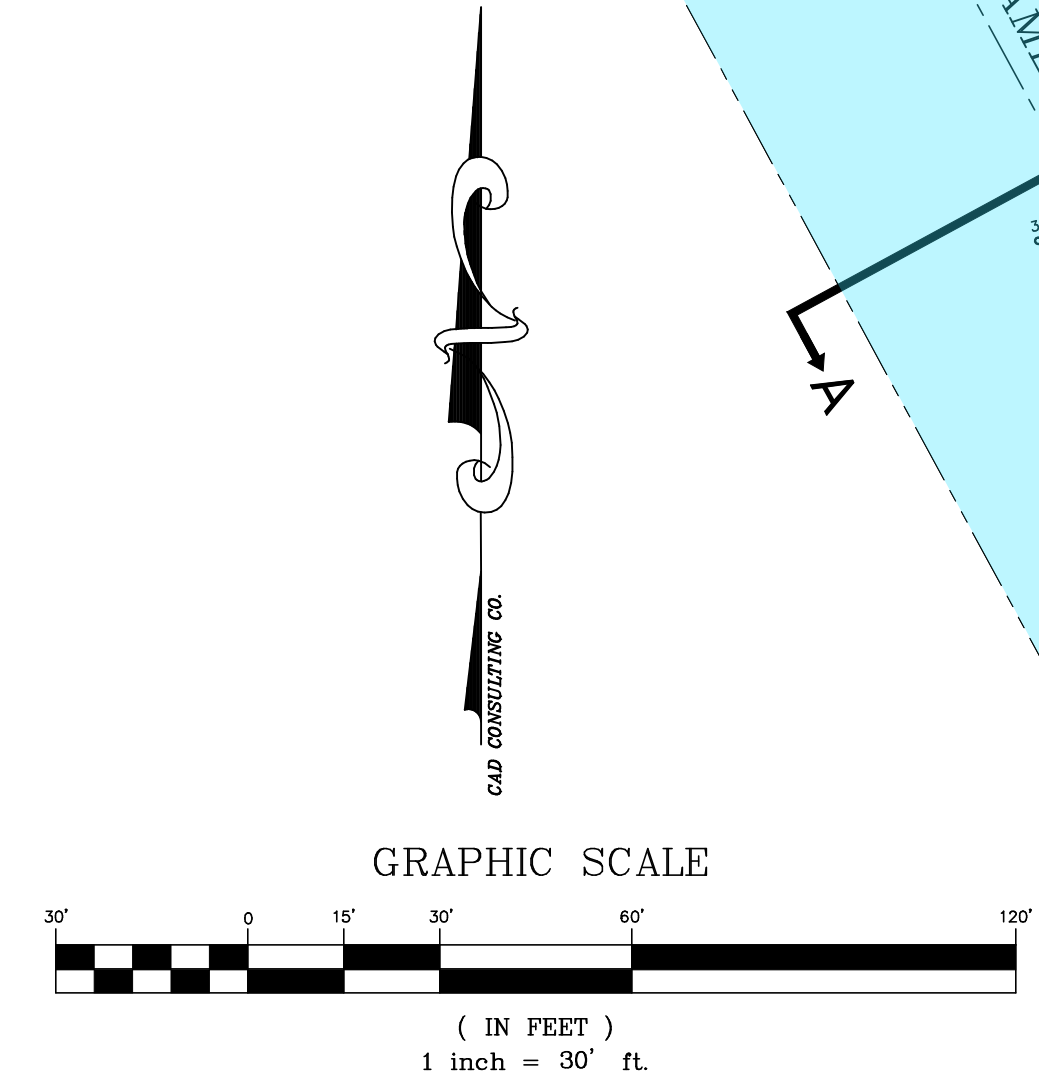

COPYRIGHT © 2025 CAD CONSULTING CO. ALL RIGHTS RESERVED

CAD CONSULTING COMPANY
1790 LEE TREVINO DRIVE SUITE 309
EL PASO, TEXAS 79936
TEL(915) 633-6422 FAX(915) 633-6424

OWNER/DEVELOPER:
LIZALAN LLC,
MARTIN ARMENDARIZ
8450 ALAMEDA AVENUE
EL PASO, TEXAS 79907
PHONE: (915) 633-6422

SURVEYOR:
CAD CONSULTING CO.
CARLOS M. JIMENEZ
1790 N. LEE TREVINO
EL PASO, TEXAS 79936
PHONE: (915) 633-6422