

Right-of-way Café Program

Space reserved for the ASL
interpreter

Do not move, modify, or add
any information on this box.



Key Milestones



Sun City
Safe

Pilot Program
in response to
COVID 19
safety orders



Right of
Way Café
Program

- Sidewalk
Café Permit
- Parking
Parklet
Permit

Space reserved for the ASL
interpreter

Do not move, modify, or add
any information on this box.

3 Sun City Safe to ROW Cafe Program

ROW CAFÉ + COMPLETE STREETS

Project Objectives – The Bigger Picture

- ✓ Improve pedestrian **experience**
- ✓ **Expand** seating & dining options
- ✓ Economic **growth** & Job creation
- ✓ **Increase** social interaction & Community engagement
- ✓ Prioritize **safety** & **accessibility**

Space reserved for the ASL interpreter

Do not move, modify, or add any information on this box.

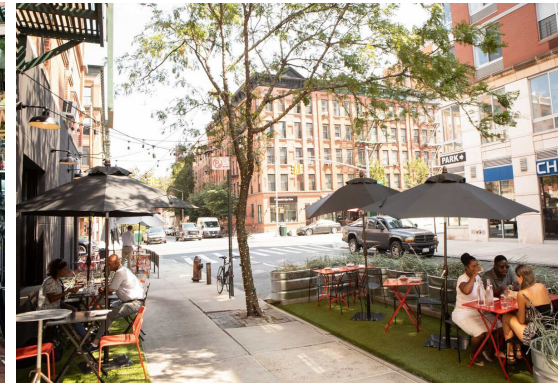

Sidewalk Café & Parking Parklet Permit

The ROW Café Program presents the opportunity to transform a designated areas of the city into a vibrant, pedestrian-friendly urban space for Food & Beverage establishments.

Space reserved for the ASL interpreter

Do not move, modify, or add any information on this box.

Sidewalk Café



Parking Parkle



5 Process Enhancements



Design Guidelines Handbook

The intent of process enhancements for the new design guidelines is to improve the efficiency, effectiveness, and overall quality of the design review process.

Accessibility of information

- § Online information & Application
- § Design Manual (Handbook)

Streamline the process

- § Standardized Development Agreement
- § Simplify Application Procedure
- § Permit duration of 2 years (Sidewalk & Parklet)
- § 3-month advance notice for permit renewals

Space reserved for the ASL interpreter

Do not move, modify, or add any information on this box.

3.1 PERMIT PROCESS FLOW CHART

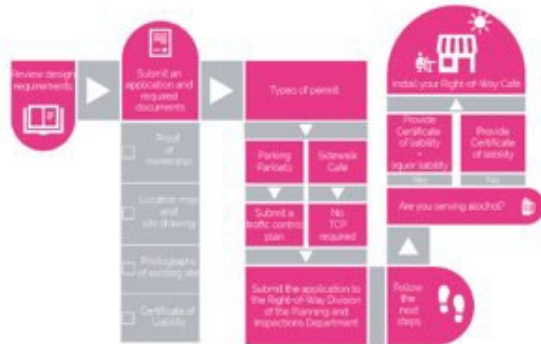

3.1 APPLICATION PROCESS

01	INTRODUCTION		04	SIDEWALK CAFÉ	
1.1 WHAT IS THE RIGHT-OF-WAY?	8		4.1 INTRODUCTION	22	
1.2 ABOUT RIGHT-OF-WAY CAFES	9		4.2 LOCATION REQUIREMENTS	23	
1.3 WHEN IS A PERMIT NECESSARY?	9		4.3 DESIGN REQUIREMENTS	24	
1.4 WHO MAY APPLY FOR A PERMIT?	9		4.4 ACCESSIBILITY REQUIREMENTS	25	
			4.5 FIRE CODE REQUIREMENTS	26	
			4.6 OTHER REQUIREMENTS	27	
			4.8 CASE STUDY #1	28	
			4.9 CASE STUDY #2	29	
02	TYPES OF PERMITS		05	PARKING PARKLET	
2.1 SIDEWALK CAFÉ	12		5.1 INTRODUCTION	34	
2.2 PARKING PARKLET	12		5.2 LOCATION REQUIREMENTS	35	
			5.3 DESIGN REQUIREMENTS	36	
			5.4 ACCESSIBILITY REQUIREMENTS	36	
			5.5 FIRE CODE REQUIREMENTS	37	
			5.6 OTHER REQUIREMENTS	37	
			5.7 CASE STUDY #1	38	
			5.8 CASE STUDY #2	39	
03	APPLICATION PROCESS		06	ADDITIONAL INFORMATION	
3.1 PERMIT PROCESS FLOWCHART	46		6.1 INDEX	48	
3.2 INSTRUCTIONS FOR APPLICATION	47		6.2 TRAFFIC CONTROL EXAMPLES	49	
3.8 INSURANCE REQUIREMENTS	48				
3.5 SITE MAP EXAMPLE	49				

ROW CAFÉ PROGRAM

Sidewalk Café Permit

AMENDMENTS TO EXISTING
ORDINANCE/PROCESS TO
FACILITATE & EXPEDITE
APPLICATIONS

Space reserved for the ASL
interpreter

Do not move, modify, or add
any information on this box.



7 Sidewalk Café

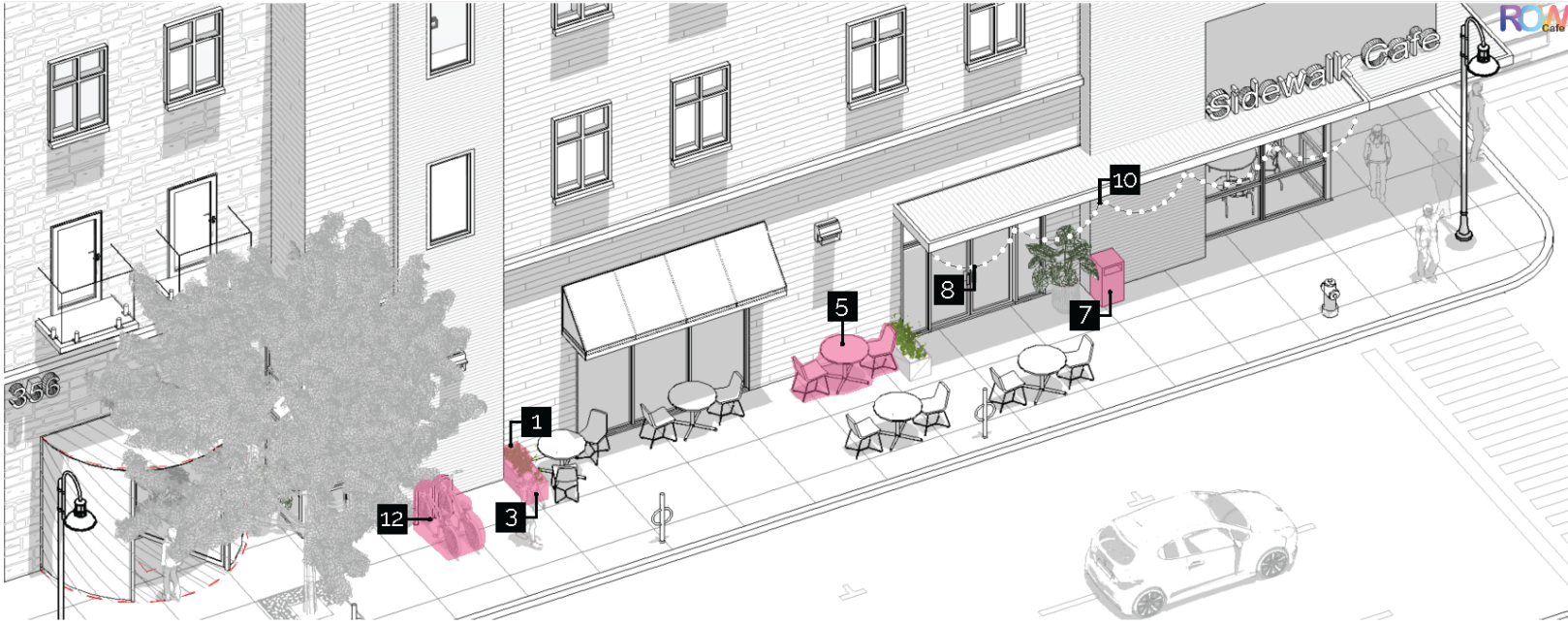

4.2 DESIGN REQUIREMENTS

1. The sidewalk café shall not be enclosed by permanent structures.
2. If fencing is provided, fencing shall be continuous around the perimeter of the patio café except for entry points. Fences must have a durable professional finish and shall comply with applicable historic district guidelines.
3. Planters may be used as barriers to delineate the café limits. Barriers must be 30" - 36" in height.
4. All construction and additions shall comply with any applicable historic district design standards and guidelines.
5. The sidewalk café must consist of moveable furniture. All furniture should be designed for outdoor use. Furniture must be able to withstand heavy weather conditions.
6. All materials must be suitable for outdoor use.
7. Each outdoor sidewalk café shall have a trash receptacle within the café limit line, not including the City of El Paso trash receptacles.
8. Any light fixtures, awnings, umbrellas, extension cords, etc., shall not protrude into the clear pedestrian path.
9. Lighting on fencing may be permitted to add a decorative element but shall not be designed to attract attention.
10. Flashing lights are not permitted. Lighting shall be clear or white.
11. Light strands shall be maintained in good repair, and burned-out bulbs shall be replaced promptly.
12. Street furniture and fixtures by the City of El Paso, such as bike racks, benches, light fixtures, and others, must be available at all times.
13. Objects like umbrellas and heating devices should be designed to endure wind speeds of 20 mph or higher, and measures must be taken to prevent them from becoming airborne.
14. Loose furniture, including tables, chairs, umbrellas, shades, portable heaters, portable light fixtures, and other items, must be removed from the row during wind advisories of 30 mph or more.

Space reserved for the ASL interpreter

Do not move, modify, or add any information on this box.

SIDEWALK CAFE (ONE-WAY STREET)

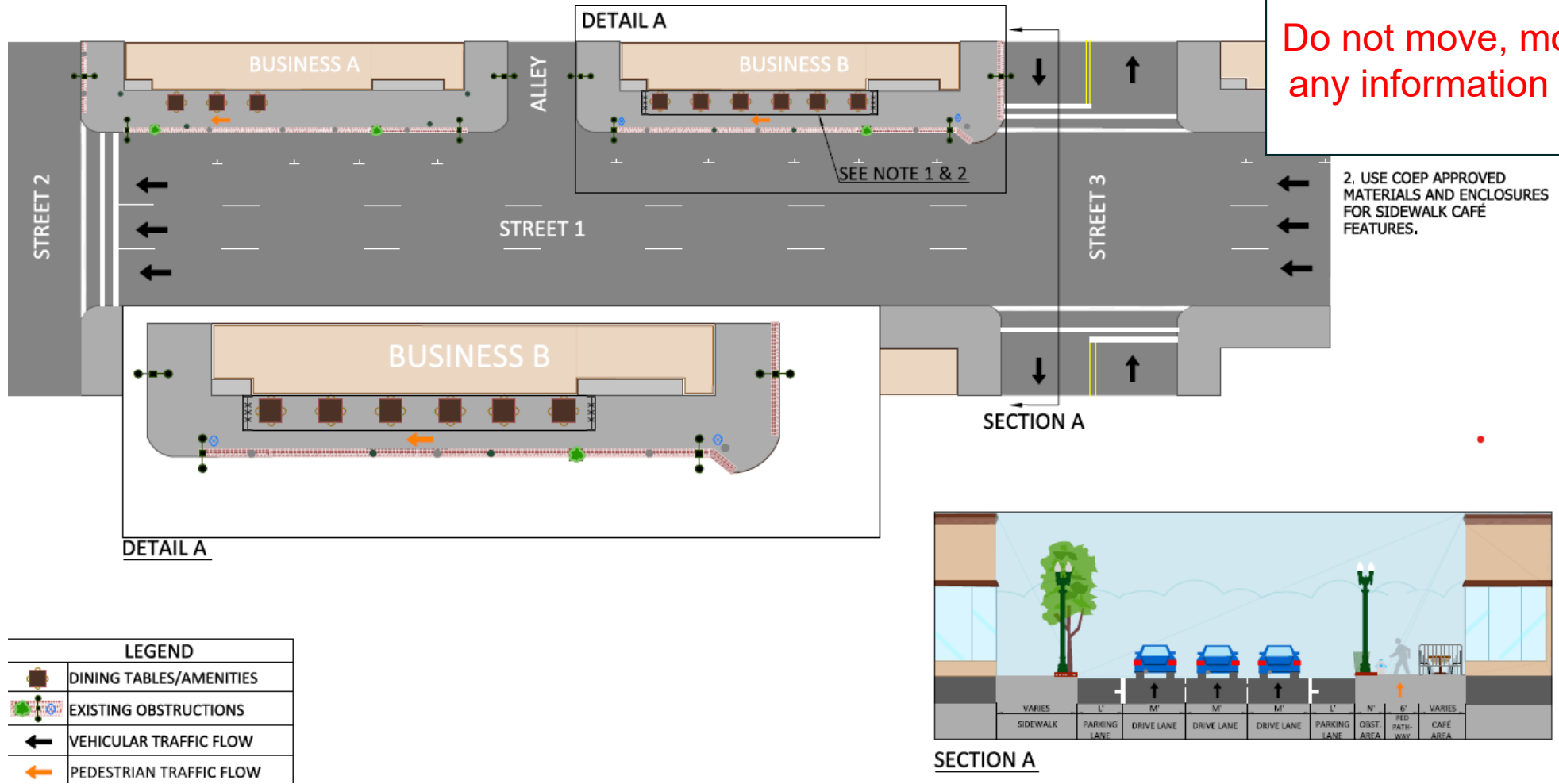







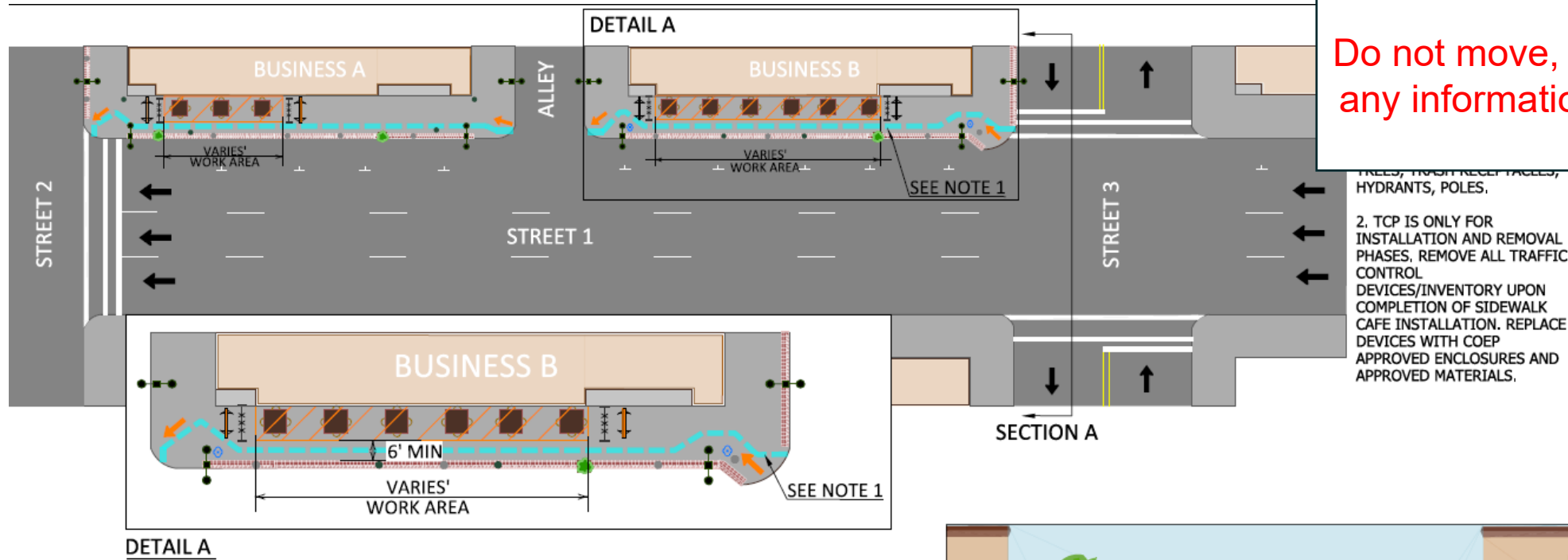





SIDEWALK CAFE (ONE-WAY STREET) - TCP

Space reserved for the ASL interpreter

Do not move, modify, or add
any information on this box.



LEGEND			
	A-FRAME TYPE I BARRICADE		DINING TABLES/AMENITIES
	TYPE III BARRICADE		EXISTING OBSTRUCTIONS
	ORANGE WATER BARRIER		ADVANCED WARNING SIGN
	STEEL BARRICADE		PEDESTRIAN PATHWAY TO BE MAINTAINED
	WORK AREA		VEHICULAR TRAFFIC FLOW
	CHANNELIZING DEVICES		PEDESTRIAN TRAFFIC FLOW

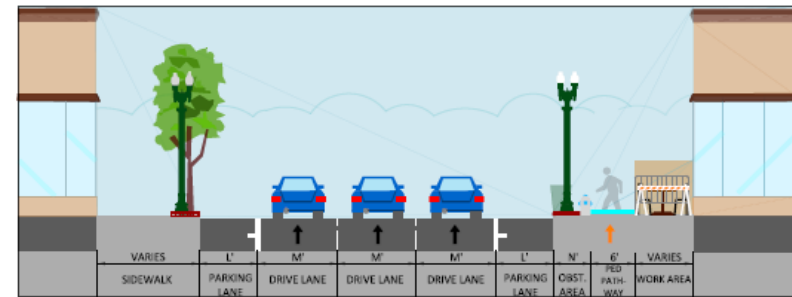

SECTION A

ROW CAFÉ PROGRAM

Parking Parklet Permit

Sidewalk extension that provides more space and amenities for people using the street for parking parklets.

Space reserved for the ASL interpreter

Do not move, modify, or add any information on this box.

11 Parking Parklet



5.1 LOCATION REQUIREMENTS

1. The parklet must utilize the parking spaces directly in front of the business. It should not extend beyond without written permission from the neighbouring businesses.
2. Parklets are permitted on streets with speed limits of 35 mph or less; any other will be considered on a case-by-case basis.
3. Parklets are not permitted on streets owned by the Texas Department of Transportation (TxDOT).
4. Parklets must be located at least 20 feet from any adjacent intersection, street corner, or crosswalk.
5. Parklets are not permitted along red and yellow painted curbs.
6. Maintain a 15 feet clear space at the base of existing fire hydrants.
7. Parklets are prohibited at bus stops, loading zones, or designated bike lanes.
8. Parklets are not permitted over utility access panels, manhole covers, transformers, water meters, or water valves. All parklets shall maintain a minimum of 5 feet from any storm drain, inlets, or cleanouts.
9. Parklets proposed along the streetcar route will be considered on a case-by-case basis and must be approved by Sun Metro prior to approval.
10. Parklets located next to driveways must have a minimum 10 feet setback from the outside edge of the driveway.
11. Parklets are not allowed within 50 feet of the nearest rail of a railroad crossing.
12. Maintain a minimum distance of 20 feet from the driveway entrance of a fire station. Additionally, Parklets are prohibited from being directly across from such entrances or within 75 feet of them.
13. Parklets are permitted on metered parking spaces only.

Space reserved for the ASL interpreter

Do not move, modify, or add any information on this box.

12 Parking Parklet Safety Standards

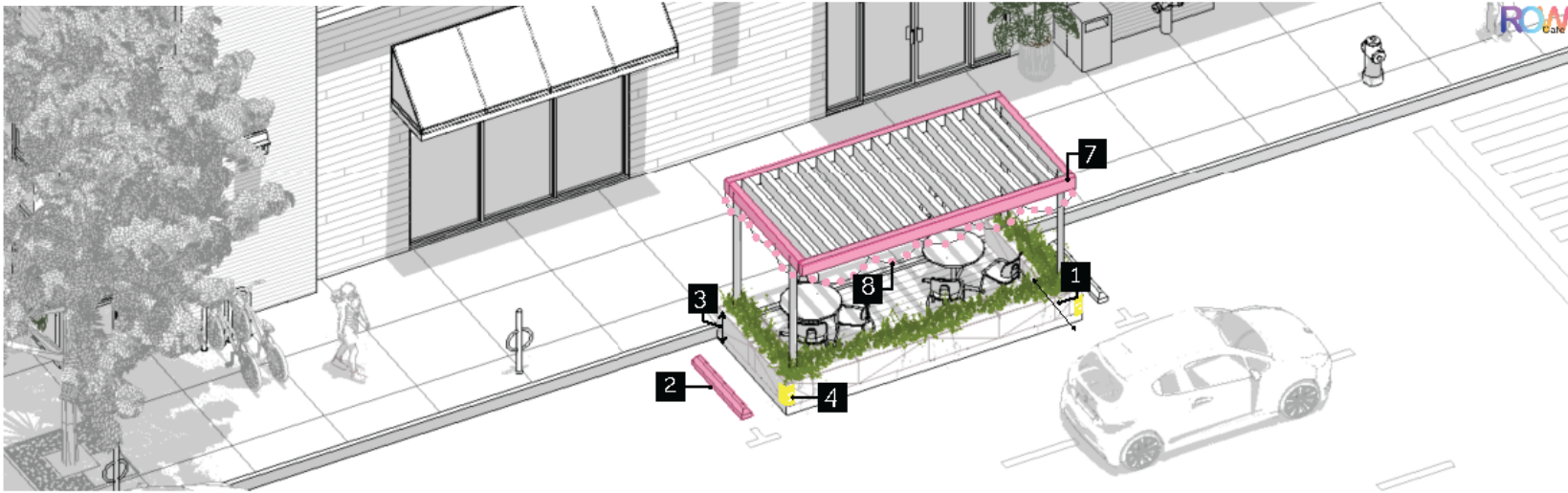

5.2 DESIGN REQUIREMENTS

1. Maintain a minimum 2 feet setback between the parking parklet seating area and adjacent on-street parking spaces and travel lanes.
2. Wheel stops, or posts must be included to separate the occupied parking space and the adjacent parking spaces and travel lane.
3. Provide a 42" high barrier at the edge of the parking parklet as a barrier to vehicular traffic. If cable railing is used, spacing between cables must not exceed six inches (see materials section.)
4. Reflectors must be included at each end of the parking parklet.
5. Parklets must include vertical elements that make them visible to traffic, such as reflective delineator posts or reflective plastic drums.
6. Parklets may not occupy more than three parking spaces. No design element may encroach into adjacent parking spaces.
7. Umbrellas or canopies may not encroach on the pedestrian travel path, travel lanes, or adjacent parking spaces.
8. The parklet must include lighting if intended for night use. Any lighting must comply with the dark sky ordinance.
9. Parklets must be equipped with a deck or platform that is flush with the adjacent sidewalk, with a maximum gap of 1/2 inch.
10. Maintain an equal grade with the adjoining sidewalk.
11. The parklet base must not be attached or bolted to the street in any manner. Instead, it should be constructed as a self-supporting structural foundation that rests directly on the street surface. The frame of the parklet should not be permanently affixed to the street or curb, and no permanent modifications or alterations to the street are permitted.
12. Access must be provided underneath the flooring of the parklet for cleaning purposes.
13. No loose particles such as sand or loose stone are permitted as surface materials.
14. The parklet must be designed to allow rainwater to flow along the curb without obstructions. The entire parklet structure should be built to allow for easy removal of the parklet if necessary.
15. All materials must be high quality, durable, non-reflective, and weather-resistant.
16. Objects like umbrellas and heating devices should be designed to endure wind speeds of 20 mph or higher, and measures must be taken to prevent them from becoming airborne.
17. Loose furniture, including tables, chairs, umbrellas, shades, portable heaters, portable light fixtures, and other items, must be removed from the row during wind advisories of 30 mph or more.

Space reserved for the ASL interpreter

Do not move, modify, or add any information on this box.

The parklet must be located:

- On streets with a speed limit of **35mph or less**
- At least **20 feet** from any **intersection or crosswalk**
- At least **10 feet** from any **driveway**
- At least **15 feet** from **fire hydrants**

Parklets may not be located:

- In TxDOT right-of-Way
- Along yellow or red painted curbs
- At bus stops, loading zones, or designated bike lanes

PARKLET (ONE-WAY STREET)

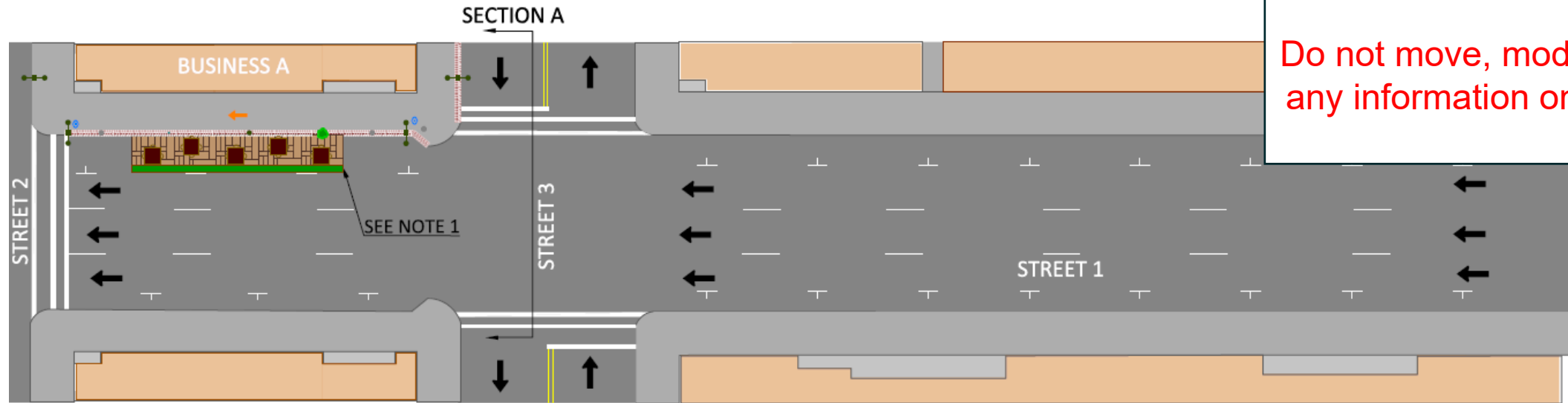

Space reserved for the ASL interpreter

Do not move, modify, or add any information on this box.

NOTES:

1. ACTUAL PARKLET FEATURES WILL VARY, ENCLOSURE TO BE PROVIDED PER COEP APPROVED MATERIALS.

LEGEND	
	DINING TABLES/AMENITIES
	EXISTING OBSTRUCTIONS
	VEHICULAR TRAFFIC FLOW
	PEDESTRIAN TRAFFIC FLOW

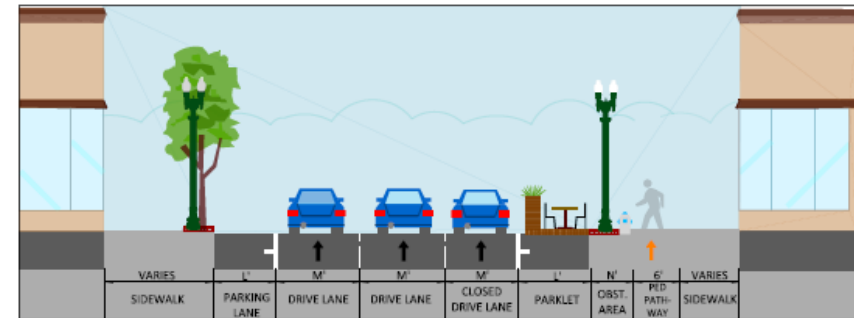

SECTION A

PARKLET (ONE-WAY STREET) - TCP

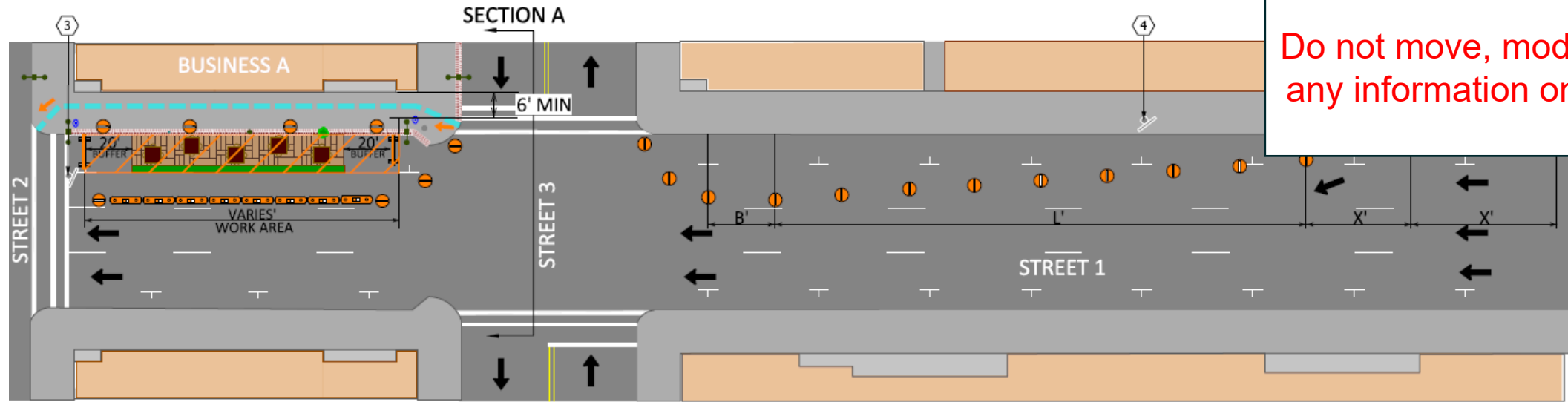

Space reserved for the ASL interpreter

Do not move, modify, or add any information on this box.

NOTES:

1. TCP IS ONLY FOR INSTALLATION AND REMOVAL PHASES. REMOVE ALL TRAFFIC CONTROL DEVICES/INVENTORY UPON COMPLETION OF PARKLET INSTALLATION. REPLACE DEVICES WITH COEP APPROVED ENCLOSURES AND APPROVED MATERIALS.

LEGEND			
	A-FRAME TYPE I BARRICADE		DINING TABLES/AMENITIES
	TYPE III BARRICADE		EXISTING OBSTRUCTIONS
	ORANGE WATER BARRIER		ADVANCED WARNING SIGN
	STEEL BARRICADE		PEDESTRIAN PATHWAY TO BE MAINTAINED
	WORK AREA		VEHICULAR TRAFFIC FLOW
	CHANNELIZING DEVICES		PEDESTRIAN TRAFFIC FLOW



CW20-1D
36"X36"
1



CW20-5TR
36"X36"
2



G20-2
36"X18"
3



R7-1 DBL
12"X18"
4
(INSTALL TEMPORARY NO PARKING SIGN DURING WORK ACTIVITIES)

POSTED SPEED LIMIT	CHANNELIZING DEVICE "B" (FT)	SIGN SPACING "X" (FT)	CLOSED LANE WIDTH (FT):		
			10	11	12
25	25	100	105	115	125
30	30	120	150	165	180
35	35	160	205	225	245

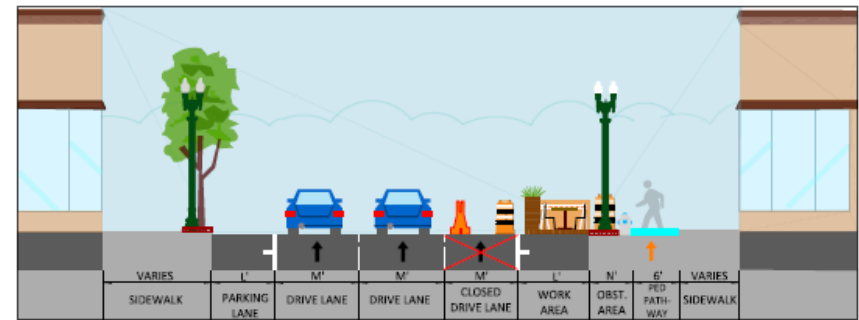

SECTION A

Proposed Code Amendments

Title 15

- Add provisions to 15.08 for Parklets
- Add references to new Design Guidelines for ROW Café Program
 - Sidewalk Café (Revised)
 - Parking Parklet (New)
- Establish a permit duration of two years and stipulate a three-month notice period for permit renewal

Space reserved for the ASL interpreter

Do not move, modify, or add any information on this box.

Permit Fees



Space reserved for the ASL interpreter

Do not move, modify, or add any information on this box.

Right-of-Way Café Program	Sidewalk Café Permit	Parking Parklet
Application Fee	\$371.00 + applicable technology fee	\$371.00 + applicable technology fee
Annual Fee	\$159.00 per site	\$2,000.00 per metered space
Total	\$530.00	\$2,371.00



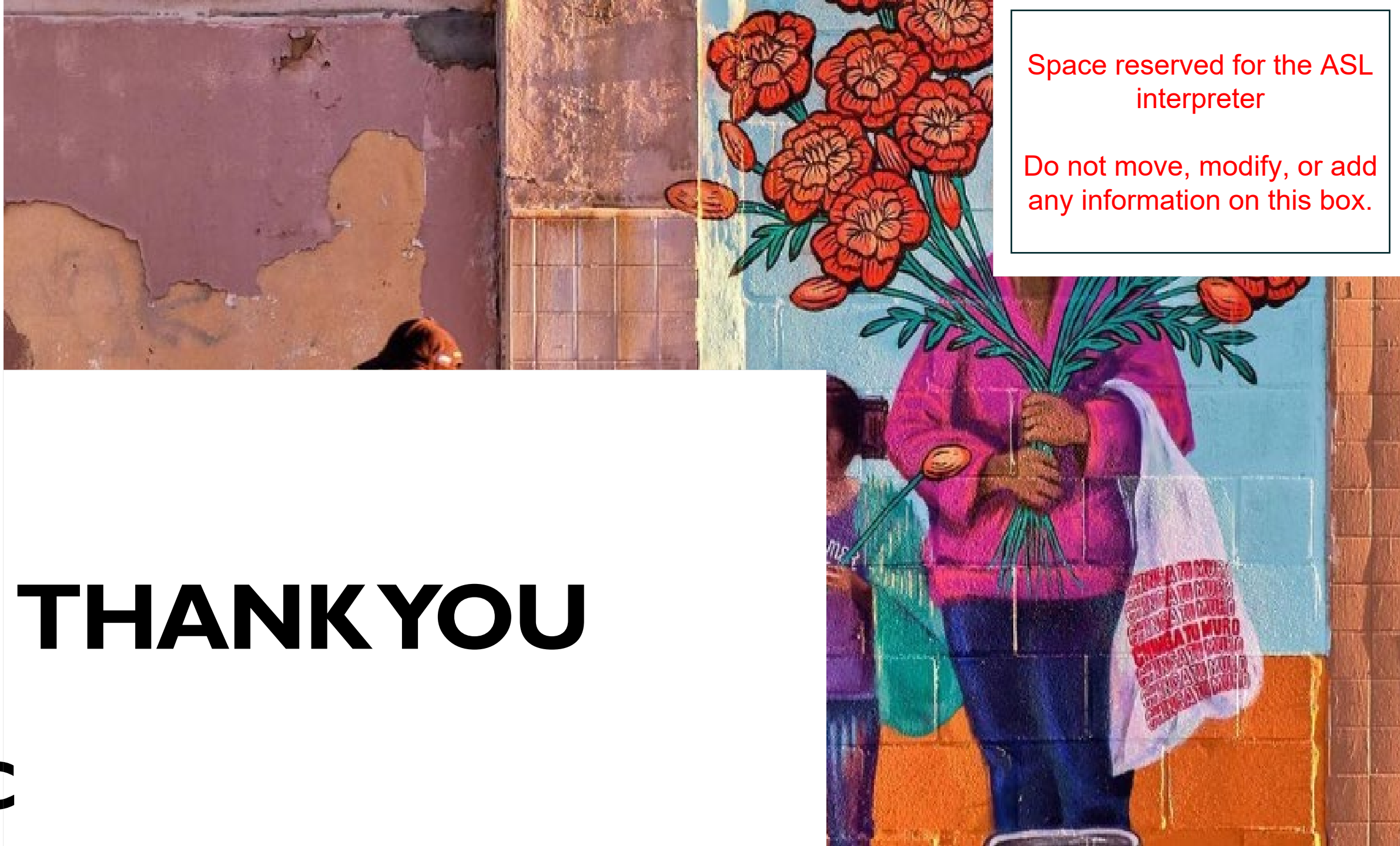

Space reserved for the ASL
interpreter

Do not move, modify, or add
any information on this box.

THANK YOU

Case Studies: Parking Parklets

(One Metered Parking Space cost)

Space reserved for the ASL interpreter

Do not move, modify, or add any information on this box.

City	New York	Atlanta	Austin	Seattle	Phoenix	Current Meter Rental Fee (A)	Proposed ROW Café Permit
Daily fee	\$0	\$1.37 - \$18.37	\$33 - \$80	±\$8.21 day	\$4.93	\$20	-
Annual fee	\$0	\$500 - \$6,705	\$12,045 - \$29,200	\$3,000 per year	\$1,800	\$7,300	\$2,000
Application fee	\$0	\$250	\$410	\$1,500	\$500	\$35	\$371
Total	\$0	\$750 - \$6,955	\$12,455 - \$29,610	\$4,500	\$2,300	\$7,335	\$2,371

*Sidewalk café will remain with current fees