



ITEM 5

The Mike G's Downtown Birthday Block Party

CSEV23-00068

Strategic Goal 4.

Enhance El Paso's quality of life through recreational, cultural and educational





Background

State Right-of-Way Impacted:

Texas Avenue between Campbell Street and Ochoa Street

Event Date and Time:

Sunday, September 3, 2023 at 12:00 p.m. to 1:00 a.m.

Street Closure Dates and Times:

Saturday, September 2, 2023, at 5:00 p.m. to 6:00 a.m., Monday
September 4, 2023



CSEV23-00068



This map is designed for illustrative purposes only. The features depicted here are approximate and more site-specific studies may be required to draw accurate conclusions. Enlargements of this map to scales greater than its original contribute errors and may lead to misinterpretation of the data. The Planning & Inspections Department Planning Division makes no claim to its accuracy or completeness.

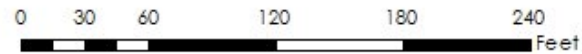

Site Plan

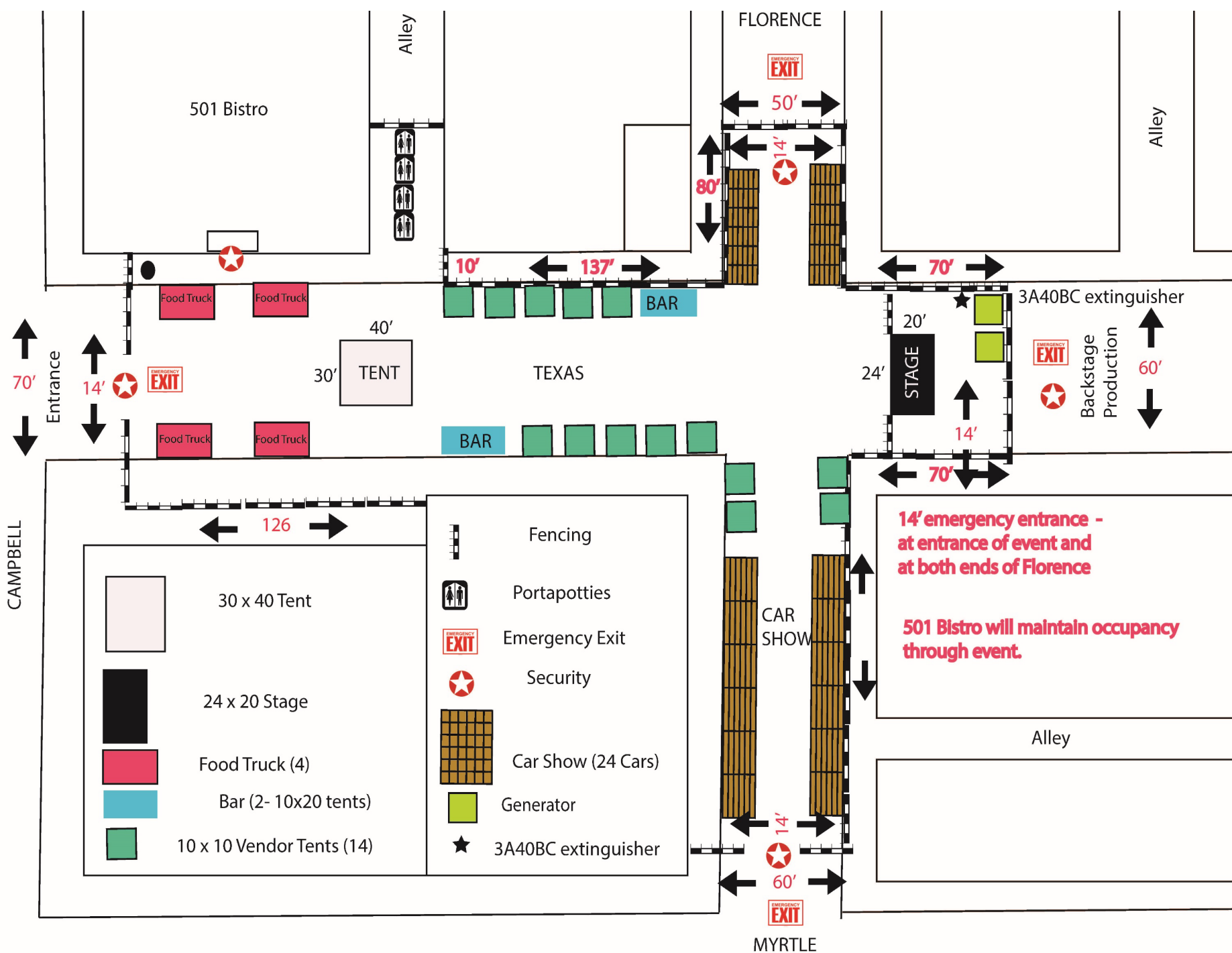

14' emergency entrance - at entrance of event and at both ends of Florence

501 Bistro will maintain occupancy through event.

TRAFFIC BARRICADE SERVICE

Roman Enriquez
 Traffic Control Planning
 Traffic Barricade Service
 6621 Doniphan Dr. Ste. M
 Canutillo, TX 79835
 (915) 838-5866
 am.trafficbarricade@yahoo.com

POSTED SPEED LIMIT (M.P.H.)	"X" SIGN SPACING (FEET)
30	120
35	160
40	240
45	320
50	400
55	500

Mike G's Downtown Block Party / CSEV23-00068

Project: Downtown Special Event
 TTC: Short Term Multi-Road Closure
 Closure Times: Sat 5pm - Mon 8am

 /  - Type III w/ Channelizing Drum
 - Cones
 - Warning Sign w/ Stand
 - Channelizing Drum w/ Warning Sign
 - Work Zone



Posted Speed	Formula	Minimum Desirable Taper Lengths *			Suggested Maximum Spacing of Channelizing Devices	
		10' Offset	11' Offset	12' Offset	On a Taper	On a Tangent
30	L = WS ²	130'	180'	180'	30'	60' - 75'
35		205'	225'	240'	30'	60' - 90'
40	L = WS	280'	290'	320'	40'	80' - 100'
45		430'	490'	540'	40'	90' - 110'
50	L = WS	580'	590'	600'	50'	100' - 125'
55		690'	690'	660'	50'	110' - 140'
60	L = WS	850'	715'	720'	60'	120' - 150'
65		950'	715'	730'	60'	130' - 160'
70	L = WS	1100'	790'	840'	70'	140' - 175'
75		1250'	825'	900'	70'	150' - 180'
80	L = WS	1400'	880'	940'	80'	160' - 190'
85		1550'	925'	1000'	80'	170' - 200'

* Taper lengths have been rounded off
 L = Length of Taper (ft.) W = Width of Offset (ft.) S = Posted Speed Limit (MPH)



Traffic Control Plan



EL PASO STREETS & MAINTENANCE DEPARTMENT
APPROVED EXCEPT AS NOTED:
 APPROVAL OF THIS DRAWING DOES NOT RELIEVE THE CONTRACTOR OF THE RESPONSIBILITY FOR THE CORRECTNESS OF DETAIL AS PER THE TEXAS MUTCD.

NOTES:

- The Traffic Control Procedure Shown is Appropriate Only for Low Volume, Low Speed Facilities, Such as Local Residential Streets.
- Flashing Warning Lights & Retro-reflective Strips Will Be Used for Night Time Barricading.
- Additional CW20-SR Signs and/or Barrels May Be Needed for High Volume, High Speed Urban Streets.
- All Traffic Control Devices Shall Be In Conformance to the Texas Manual on Uniform Traffic Control Devices (TMUTCD).
- Flagmen Must be Present on Each Construction Site Anytime Equipment is Being Operated on or is Impeding into Roadway or Sidewalk Area.
- Sidewalks to be Closed Per Approved Methods Anytime Work is Impeding into or Over the Travel Path.
- All Traffic Control Devices Shall be Maintained in Conformance to the Texas Manual on Uniform Traffic Control Devices (TMUTCD).
- Additional Service Plan to be in Place for Response to Inclement Weather Conditions.

EPTC23-03364
TRAFFIC CONTROL PLAN
 SHALL COMPLY WITH THE LATEST EDITION OF THE TEXAS MANUAL OF UNIFORM TRAFFIC CONTROL DEVICES
ONE DAY PERMIT UNLESS NOTED
 CLOSURE DATE: 09/02/2023-09/04/2023
 TIME: SAT 5PM - MON 8AM ONLY
 BY:  DATE: 08/15/2023





Mission

Deliver exceptional services to support a high quality of life and place for our community



Vision

Develop a vibrant regional economy, safe and beautiful neighborhoods and exceptional recreational, cultural and educational opportunities powered by a high performing government



Values

Integrity, Respect, Excellence, Accountability, People