



# Hueco Mountain Park Seville Futsal Court Park E.L. Williams Phase II

## Improvements

Solicitation No. 2021-0621

February 16, 2021



# Project Details

	<u>Hueco Mountain Park</u>	<u>Seville Futsal Court Park</u>	<u>E.L. Williams Phase II Improvements</u>
Location(s):	1184 E.Vitex Circle ;	6705 Sambrano Avenue ;	752 Lafayette Drive
District(s):	Five (5) ;	Three (3) ;	Seven (7)
Total Budget(s):	\$139,400.00 ;	\$331,200.00 ;	\$225,500.00
Funding Source:	Community Development Block Grant		

# Project Location – Hueco Mountain Park



# Project Location – Seville Futsal Court Park



# Project Location – E.L. Williams Phase II Improvements



# Existing Condition – Hueco Mountain Park



# Existing Condition – Seville Futsal Court Park



# Existing Condition – E.L. Williams Phase II Improvements





# Scope of Work – Hueco Mountain Park

- Construction of Metal Shade Canopy including canopy posts, footings, concrete drilling, anchors, fasteners and various items relevant to said project for existing playground.

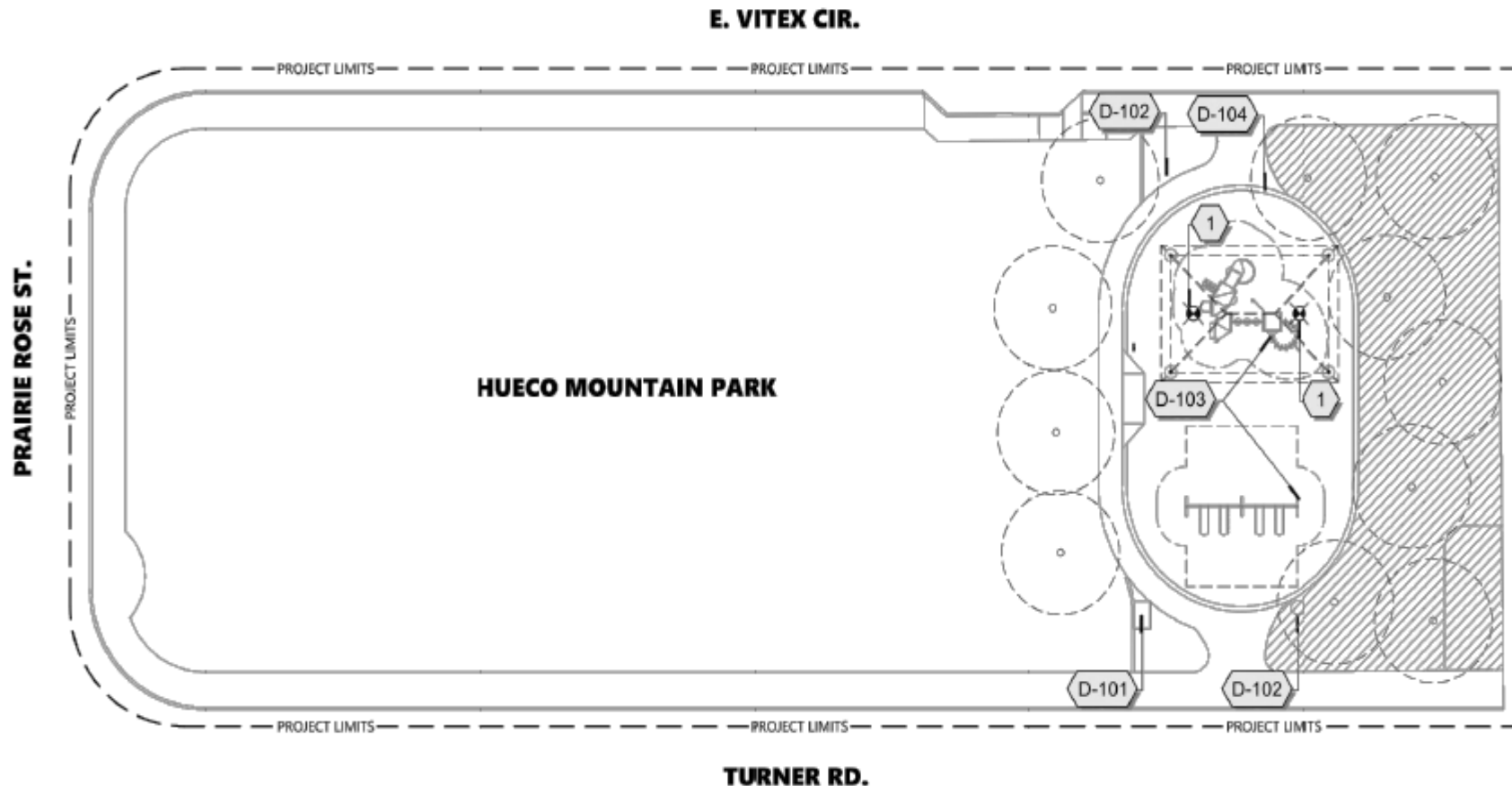

## REFERENCE NOTES SCHEDULE

SYMBOL	DESCRIPTION
	CONTRACTOR SHALL PROVIDE SHOP DRAWINGS FOR THE ELECTRICAL SOLAR LIGHTING SHOWING THE LIGHTS COMPLY WITH ALL LOCAL AND STATE CODES.

SYMBOL	DEMOLITION DESCRIPTION
	EXISTING SIGN TO PRESERVE AND PROTECT.
	EXISTING TRASH RECEPTACLE TO PRESERVE AND PROTECT.
	EXISTING PLAYGROUND EQUIPMENT TO PRESERVE AND PROTECT.
	EXISTING ROCKWALL TO PRESERVE AND PROTECT.

SYMBOL	DESCRIPTION
	AREA TO REMAIN OFF LIMITS FOR CONSTRUCTION EQUIPMENT WITHOUT PRIOR APPROVAL IN WRITING FROM THE CITY'S PROJECT MANAGER AND LANDSCAPE ARCHITECT.

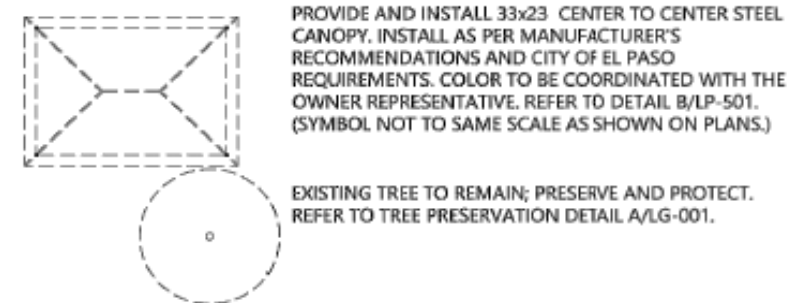

PROVIDE AND INSTALL 33x23 CENTER TO CENTER STEEL CANOPY. INSTALL AS PER MANUFACTURER'S RECOMMENDATIONS AND CITY OF EL PASO REQUIREMENTS. COLOR TO BE COORDINATED WITH THE OWNER REPRESENTATIVE. REFER TO DETAIL B/LP-501. (SYMBOL NOT TO SAME SCALE AS SHOWN ON PLANS.)

EXISTING TREE TO REMAIN; PRESERVE AND PROTECT. REFER TO TREE PRESERVATION DETAIL A/LG-001.

# Scope of Work – Seville Futsal Court Park

- Demolition and removal of curb, sidewalk, concrete driveway, rock wall, asphalt parking lot, trees and wrought iron fence.
- Construction of Futsal Court, asphalt court surface, parking space, futsal fence with goal posts, addition of benches, trash receptacles, bike rack, ADA parking spaces, ADA ramps and lighting.

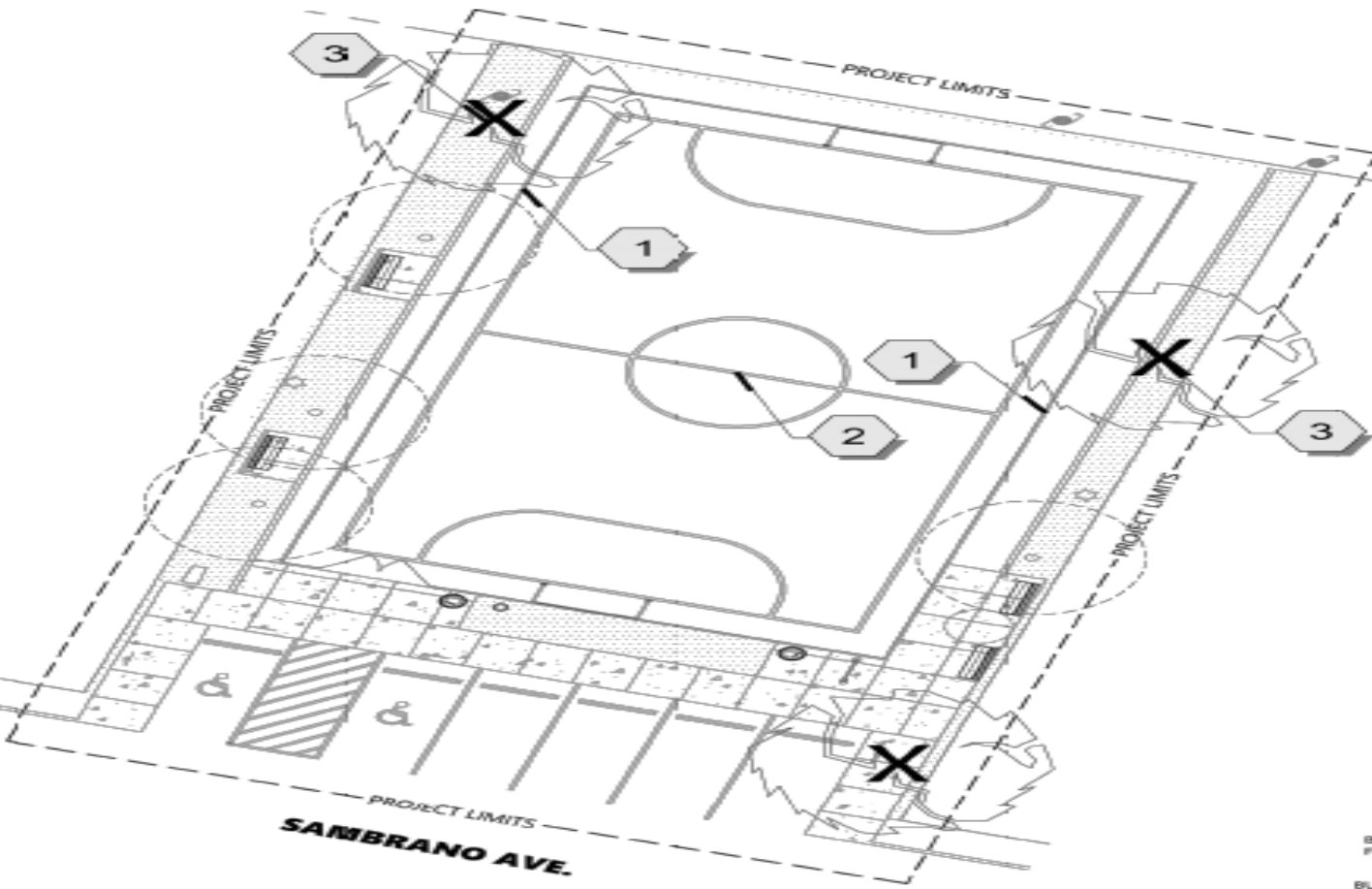

SYMBOL	DESCRIPTION
1	PROVIDE AND INSTALL MUGA STEEL COURT FENCE.
2	FUTSAL ASPHALT COURT, REFER TO DETAIL G/LC-501 FOR STRIPING LINES.
3	CAP AND REMOVE EXISTING IRRIGATION LINES.
SYMBOL	DESCRIPTION
I	PROVIDE AND INSTALL ARCHES BIKE RACK - SURFACE MOUNT, REFER TO DETAIL E/LC-501.
•	PROVIDE AND INSTALL PET WASTE STATION OR APPROVED EQUAL. REFER TO DETAIL C/LC-501
—	PROVIDE AND INSTALL POWDER COATED 6-FT. STEEL BENCH, WITH ARMREST, SURFACE MOUNT OR APPROVED EQUAL. REFER TO DETAIL B/LC-501.
•	PROVIDE AND INSTALL TRASH RECEPTACLE WITH POWDER COATED SLATES, AND 32 GAL. PLASTIC LINER, SURFACE MOUNTED OR APPROVED EQUAL. REFER TO DETAIL A/LC-501.
SYMBOL	DESCRIPTION
[Pattern]	PROVIDE AND INSTALL SALT FINISHED CONCRETE PAVING, AT 3000 PSI. REFER TO DETAIL D,F/LC-501.
[Pattern]	PROVIDE AND INSTALL PADRE CANYON SCREENINGS, 3" DEPTH WITH GCI 500 SERIES FILTER FABRIC OR APPROVED EQUAL.
[Tree Symbol]	EXISTING TREE TO REMAIN; PRESERVE AND PROTECT. REFER TO TREE PRESERVATION DETAIL B/LP-101.
[Tree Symbol]	EXISTING TREE TO REMOVE AND DISPOSE. CONTRACTOR SHALL MAKE A 1 FT. WELL AROUND THE BASE OF TREES TO BE REMOVED AND CUT TRUNK AS LOW AS POSSIBLE. REMAINING ROOTS AND STUMP WITHIN WELL SHALL BE GRINDED 18" BELOW GRADE.

# Scope of Work – E.L. Williams Phase II Improvements

- Construction of landscape, irrigation, trees, shrubs, concrete pads for benches, trash receptacles, mow strip curb and two shade canopies.

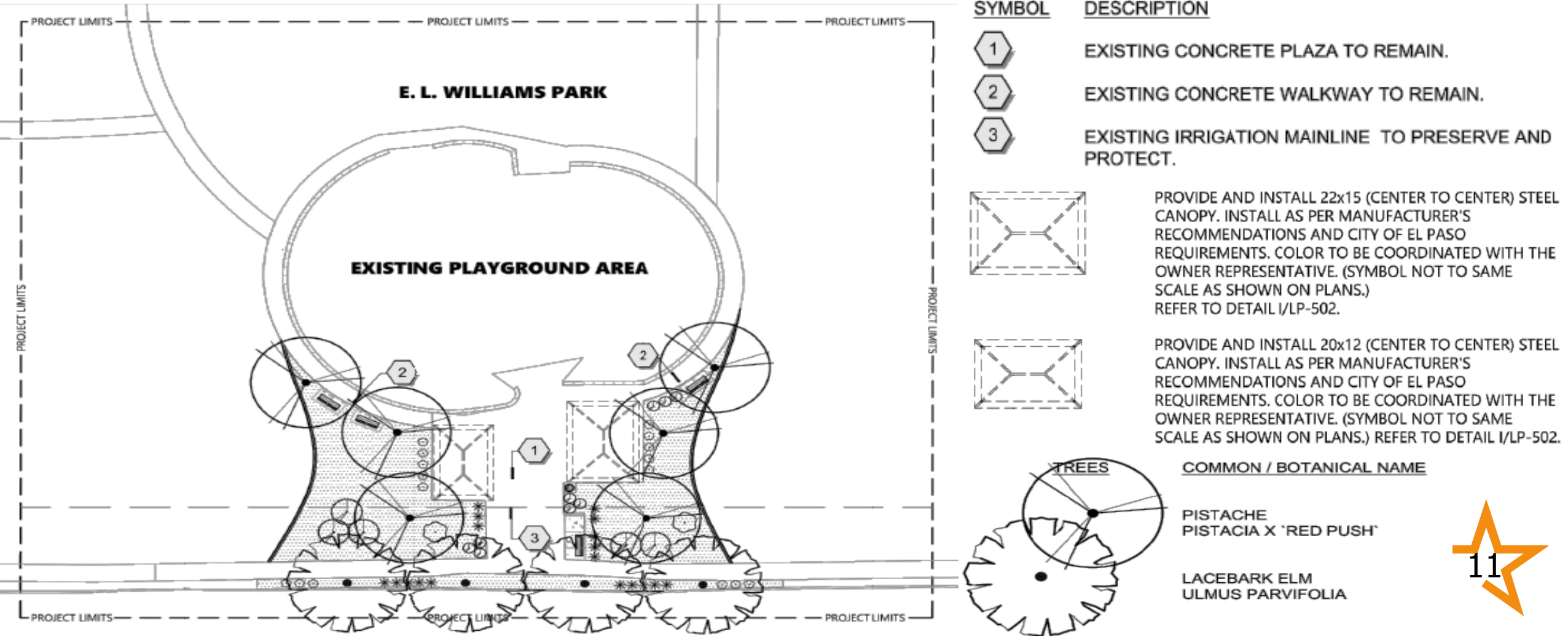

# Procurement Summary

- **Low Bid Procurement Method**
  - **Solicitation advertised on December 15, 2020 and December 22, 2020**
    - **Four (4) firms submitted bids, Four (4) local vendors**
  - **Recommendation**
    - **To award the construction contract to Martinez Bros Contractors, LLC. in the amount of \$365,773,34**
  
- **Construction Schedule**
  - **Start: Spring/2021**
  - **End: Fall/2021**



# Thank you



## Mission

Deliver exceptional services to support a high quality of life and place for our community



## Vision

Develop a vibrant regional economy, safe and beautiful neighborhoods and exceptional recreational, cultural and educational opportunities powered by a high performing government



## Values

Integrity, Respect, Excellence, Accountability, People